

TPLO Saw System

Instruction Manual



Arthrex®
Vet Systems

Application

The TPLO saw is mainly used for tibial plateau surgery.

Main Components and Accessories

Including a handpiece, charger, battery, and saw blades, the TPLO saw is fully sealed and battery-powered.

- 01. Handpiece
- 02. Battery
- 03. Charger
- 04. Aseptic Battery Transfer Ring
- 05. Allen Wrench





Technical Specifications and Parameters

Handpiece

Model/Technical Specifications	Frequency	Oscillation	Unit Rise of Temperature Within 5 Minutes	Noise
TPLO Saw	cpm	°	°C	dB
	0-16000	11.5	≤25	≤90

Charger and Battery

Charger	Nominal voltage	100-240 V
	Input frequency	50~60 Hz
	Input current	0.5 A (max)
	Output voltage	7.2~16.8 V
	Output current	1.0 A (max)
Battery	Voltage	12 V
	Charging time	≈2 hours
	Discharge time	≥15 minutes

Icon	Explanation
	Locked
	Unlocked

Installation and Instruction for Use

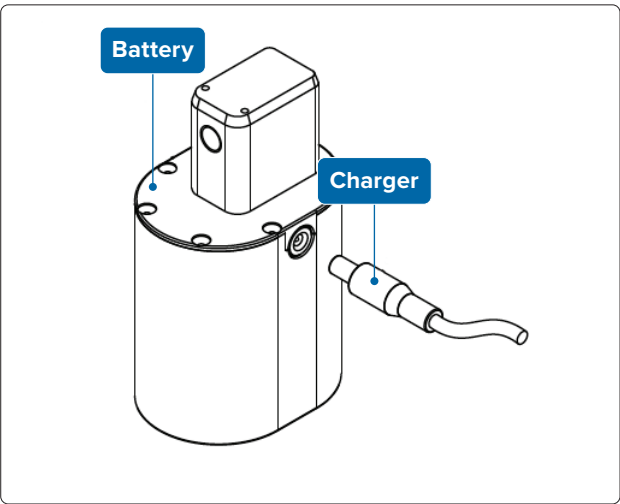

Charging the Battery

Plug the charger terminal DC interface into the battery DC port to charge.

Note: When the charger is properly connected to the power source, the indicator lights will display the following statuses: a green light indicates the charger is connected correctly, a blue light signifies the charging state, a green light shows the battery is fully charged, and a flashing blue light indicates an error.

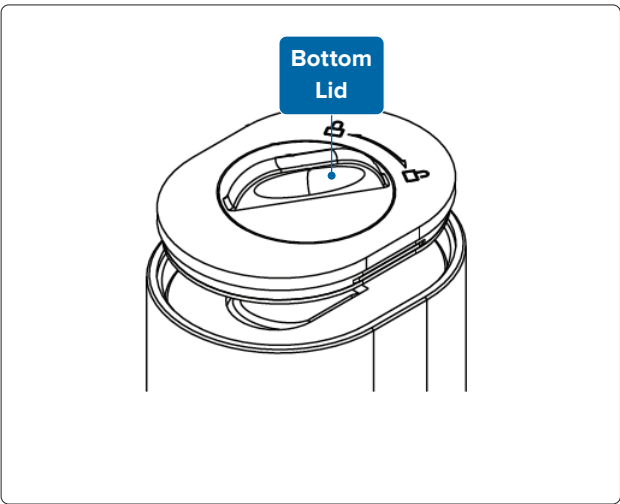

Opening and Closing the Bottom Lid

To open the bottom lid, turn the knob to the unlocking position and lift the bottom lid.

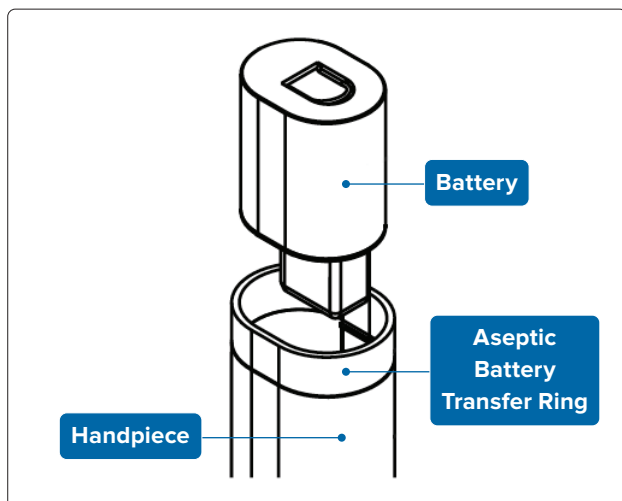

Installing the Battery

To prevent contamination, ensure the battery does not come into direct contact with the handpiece.

First, attach the aseptic battery transfer ring to the handpiece. Then, insert the battery into the battery bin through the aseptic battery transfer ring and press it into place.

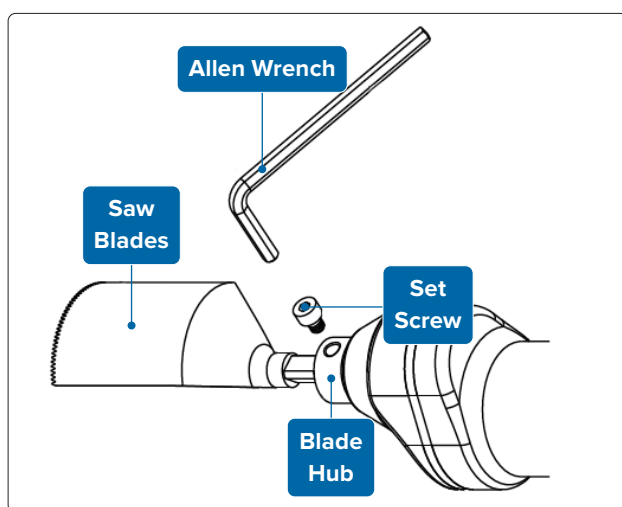

Installing the Saw Blades

Loosen the set screw using the Allen wrench, being careful not to unscrew it completely to avoid separation from the handpiece. Insert the TPLO saw blade into the hub in the desired orientation. Finally, securely tighten the set screw with the Allen wrench.

Note: This product is specialized medical equipment and should only be used by individuals with appropriate technical knowledge or by qualified medical personnel.

Picture is for use indication only.

Precautions

- › Secure the saw blade firmly with an Allen wrench to prevent accidents. Store the equipment in a dry place to prevent corrosion.
- › Avoid disinfecting the battery at high temperatures and high pressure, and do not leave it in the handpiece for extended periods. Remove the battery after each operation. If the power cuts off during use and the handpiece stops working, replace with the standby battery immediately.
- › If abnormal noise or excessive vibration occurs, turn off the motor immediately. Contact Arthrex Vet Systems Customer Service for assistance.

Reminders:

- › Ensure cutting blades are installed correctly
- › Check battery power level before each case

Cleaning and Disinfection

Cleaning

Wipe the handpiece shell with gauze soaked in water or alcohol before storing it properly.

Disinfection

Disinfect according to hospital regulations.

Sterilization

Sterilization capabilities, cleaning, disinfecting, handling, and storage of instrumentation are the responsibility of the qualified facility and/or user personnel. Qualified personnel must properly clean and disinfect the instruments prior to sterilization.

Steam Sterilization Cycle Parameters

Steam Cycle Type	Temperature	Steam Hold Time	Minimum Drying Time
Forevacuum	132°C (270°F)	4 minutes	8 minutes
Forevacuum	134°C (273°F)	4 minutes	8 minutes

Batteries cannot be sterilized at high temperatures and pressure.

Drying Method

Compressed air may be used to dry any residual water inside the battery compartment.

Maintenance and After-Sales Service

Professional staff or hospital technicians should regularly check the product's function and safety before each operation. This product is maintenance-free and does not contain any parts requiring maintenance by users or manufacturers. Keep a record of these checks to allow for timely analysis and evaluation, ensuring the product remains in good condition for qualified use.

Note: This equipment contains no parts that can be disassembled or repaired by nonprofessionals.

For assistance with malfunctions or to request technical information about the TPLO saw, please contact Arthrex Vet Systems Customer Service at CSVs@arthrex.com.

Production Date

The production date and batch number are shown on the product certificate label.

Transportation

Transportation storage condition	Ambient temperature range	-10°C~+40°C
	Relative humidity range	≤90%
	Atmospheric pressure range	500~1060 hPa
Operating Conditions	Ambient temperature range	5°C~40°C
	Atmospheric pressure range	≤70%
	Charge power	100-240 V; 50-60 Hz
	Host power	9.6-14.4 V

This description of technique is provided as an educational tool and clinical aid to assist properly licensed medical professionals in the usage of specific Arthrex products. As part of this professional usage, the medical professional must use their professional judgment in making any final determinations in product usage and technique. In doing so, the medical professional should rely on their own training and experience, and should conduct a thorough review of pertinent medical literature and the product's directions for use. Postoperative management is patient-specific and dependent on the treating professional's assessment. Individual results will vary and not all patients will experience the same postoperative activity level or outcomes.

An HCP must always refer to and comply with the relevant product labels and Directions For Use, including cleaning and sterilization instructions, before using an Arthrex product. This information provided is intended for healthcare professionals (HCPs) only. Arthrex, as the creator and distributor of its products, does not practice medicine, is not rendering medical or professional advice, and does not recommend any surgical techniques for use on a particular patient. Arthrex strongly recommends that HCPs are trained in the use of an Arthrex product before using it in a procedure or surgery. The HCP who performs any surgical procedure is responsible for determining and using the appropriate techniques for surgical procedures on each individual patient.



Arthrex manufacturer, authorized representative, and importer information (Arthrex eIFUs)



US patent information